



WINDSOR REPUBLIC DOORS

The Best Door In The Industry



MODEL 224

COMMERCIAL GRADE SECTIONAL STEEL OVERHEAD DOOR

The Model 224 is a great value in commercial grade sectional steel overhead doors. Its nominal 24 gauge textured steel construction guarantees strength and durability.

The Model 224 offers the greatest overall value in our line of sectional steel overhead doors. You can rely on years of trouble-free performance, innovative design, first quality construction and a 50-year Windsor commitment to every overhead door customer we serve.

If you have specific application questions OR need technical information about this or any Windsor Republic Door product, please call 1-800-WINDSOR for help.

STANDARD FEATURES

- 5-year limited warranty
- Door Thickness: 2"
- Nominal 24 gauge steel, hot-dipped galvanized and prepainted white, brown or almond with Ruff-Tex® finish
- Tongue and groove weathertight meeting rails
- Roll formed with integral reinforcing ribs - 6 longitudinal, 2 flat bottom v-grooves
- Hot-dipped galvanized steel end and intermediate stiles
- Bottom weatherstrip is standard bulb-type
- Tog-L-Loc™ mechanical fastening system is durable, high-strength and ensures leakproof joints
- Sizes: Widths up to 20'-2". Heights up to 16'-1"
- White, almond or brown front; white back

Counterbalance System

- Oil-tempered helical-wound torsion springs
- Tubular or solid steel shaft as required
- Cast aluminum cable drums

Track & Hardware

- Track is 2" hot-dipped galvanized steel
- Bracket mount is standard
- Vertical track is inclined to assure tight closure at the jambs
- Horizontal track is reinforced with galvanized angles as required
- Galvanized graduated hinges
- Rollers are steel ball bearing with case hardened races
- Lift cables are aircraft-type galvanized (minimum safety factor 5 to 1)

Locks

- Inside friction lock is standard

OPTIONS

- Lites: 5" x 24" glass openings
- Locks: 5-pin tumbler cylinder lock; night latch with steel bar engaging track
- Jamb, header and joint weath-erseals
- Insulation: Polystyrene with gloss liner
- High lift and vertical lift
- Angle mount

1 2" panel thickness

2 Tongue and groove weathertight meeting rails

3 Full length bulb-type bottom PVC weatherstrip

4 Hot-dipped galvanized end and intermediate stiles

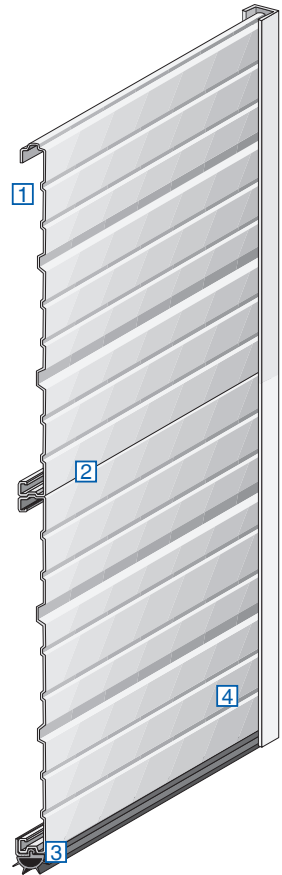

TRACK CLEARANCE SCHEDULE

(Measurement from Header to Ceiling)

	2" Track	3" Track
Standard Lift: Headroom	16"	19"
Vertical Lift: Door Height Plus	8"	8"
Hi-Lift: Hi-Lift Plus	10"	12"
Sideroom	4"	4¾"
Center Post Room	8"	9½"

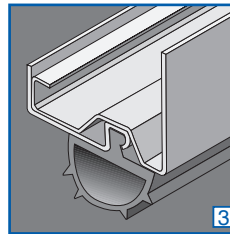

Above chart is for normal installations.

BASIC TRACK CONFIGURATIONS

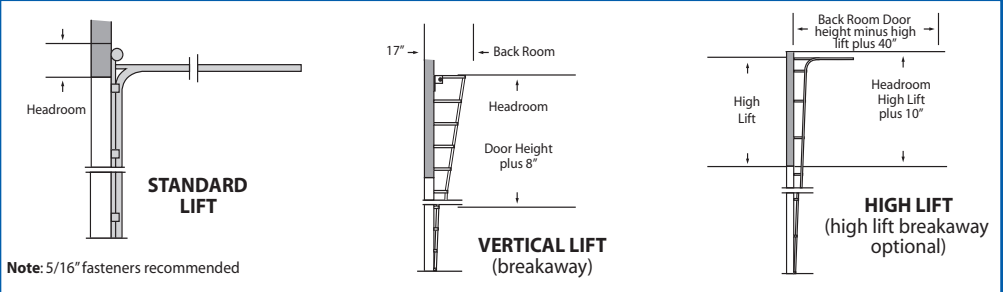

Windsor Republic Door reserves the right to change engineering specifications without prior notice.



SECURITY

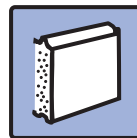

INSULATED
(OPTIONAL)

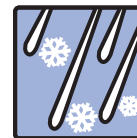

WEATHERSTRIPPED
(OPTIONAL)



VISION LITES
(OPTIONAL)

201107



5800 Scott Hamilton Drive • Little Rock, AR 72209 • 501-562-1872
1370 Furneaux Road • Marysville, CA 95901 • 530-743-1851

www.windsordoor.com

WR WINDSOR REPUBLIC DOORS

Printed 04/06

MODEL 224 COMMERCIAL GRADE SECTIONAL STEEL OVERHEAD DOOR